

OVERALL DIMENSIONS AND TECHNICAL DATA

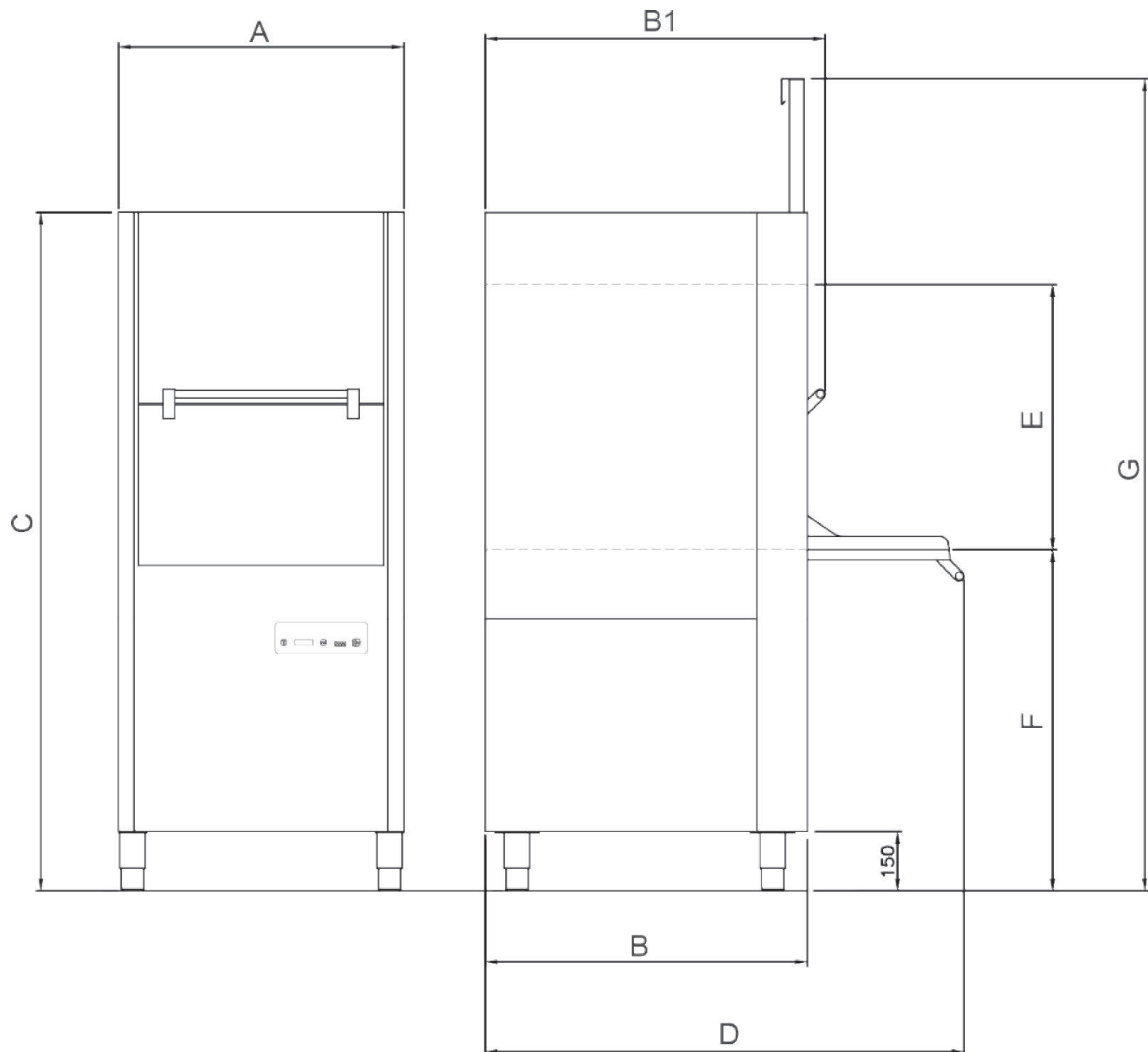

MODEL	A (mm)	B (mm)	B1 (mm)	C (mm)	D (mm)	E (mm)	F (mm)	G (mm)
HPW40 BT	720	814	858	1712	1208	670	860	2050
HPW40 ABT	720	814	858	1860	1358	820	860	2200

MODEL	Output in baskets/hour	Electrical connection	Total power	Boiler heating element	Tank heating element	Wash pump
HPW40 BT	21/15/10/8	380-415V3N ~ 50Hz	7,5 kW	6 kW	4 kW	1,5 kW
HPW40 ABT	21/15/10/8	440V 3 ~ 50/60Hz	7,5 kW	6 kW	4,2 kW	1,5 kW

MODEL	Tank capacity	Boiler capacity	Water cons. per cycle	Cycle length			
				Short	Medium	Long	Intensive
HPW40 BT	42 L	10,5 L	4,5 L	1 120 s.	2 240 s.	3 360 s.	4 480 s.
HPW40 ABT	42 L	10,5 L	4,5 L	1 120 s.	2 240 s.	3 360 s.	4 480 s.

MODEL	Drain pipe fitting	Operating and storage temp.	Relative humidity	Wash temperature	Rinse temperature
HPW40 BT	ø 1 1/2"G	5° ÷ 40° C	20 ÷ 90 %	50° ÷ 60° C	80° ÷ 90° C
HPW40 ABT	ø 1 1/2"G	5° ÷ 40° C	20 ÷ 90 %	50° ÷ 60° C	80° ÷ 90° C

MODEL	Water inlet max. temp.	Noise level	Basket dimensions	Net weight	Weight of packed machine	Water supply
HPW40 BT	50° C	< 70 dB (A)	540x660x120 mm	200 kg	236 kg	2÷4 bar Ø 3/4"G
HPW40 ABT	50° C	< 70 dB (A)	540x660x120 mm	200 kg	236 kg	2÷4 bar Ø 3/4"G

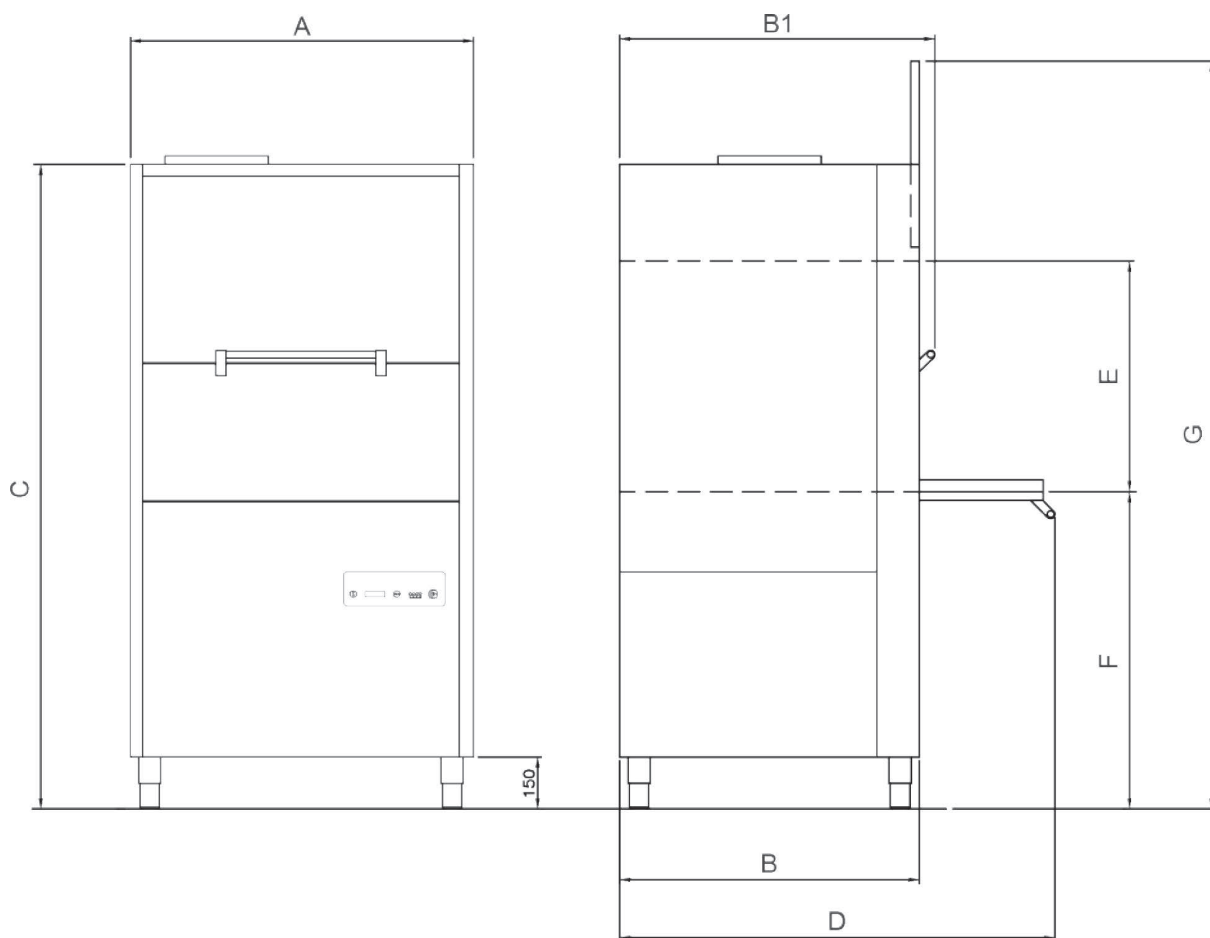

MODEL	A (mm)	B (mm)	B1 (mm)	C (mm)	D (mm)	E (mm)	F (mm)	G (mm)
HPW60 BT	836	870	915	1870	1263	670	920	2170
HPW60 ABT	836	870	915	2020	1413	820	920	2320
HPW80 BT	996	870	915	1870	1263	670	920	2170
HPW80 ABT	996	870	915	2020	1413	820	920	2320
HPW130 BT	1506	870	915	1870	1263	670	920	2170
HPW130 ABT	1506	870	915	2020	1413	820	920	2320

MODEL	Output in baskets/hour	Electrical connection	Total power	Boiler heating element	Tank heating element	Wash pump
HPW60	30/15/10/8	380-415V3N ~ 50Hz	9 kW	6 kW	6 kW	3 kW
HPW80	30/15/10/8	380-415V3N ~ 50Hz	9 kW	6 kW	6 kW	3 kW
HPW130	30/15/10/8	380-415V3N ~ 50Hz	15 kW	9 kW	9 kW	6 kW

MODEL	Tank capacity	Boiler capacity	Water cons. per cycle	Cycle length			
				Short	Medium	Long	Intensive
HPW60	82 L	14,5 L	4,5 L	1 120 s.	2 240 s.	3 360 s.	4 480 s.
HPW80	86 L	14,5 L	5 L	1 120 s.	2 240 s.	3 360 s.	4 480 s.
HPW130	132 L	14,5 L	8 L	1 120 s.	2 240 s.	3 360 s.	4 480 s.

MODEL	Drain pipe fitting	Operating and storage temp.	Relative humidity	Wash temperature	Rinse temperature
HPW60	ø 1 1/2"G	5° ÷ 40° C	20 ÷ 90 %	50° ÷ 60° C	80° ÷ 90° C
HPW80	ø 1 1/2"G	5° ÷ 40° C	20 ÷ 90 %	50° ÷ 60° C	80° ÷ 90° C
HPW130	ø 1 1/2"G	5° ÷ 40° C	20 ÷ 90 %	50° ÷ 60° C	80° ÷ 90° C

MODEL	Water inlet max. temp.	Noise level	Basket dimensions	Net weight	Weight of packed machine	Water supply
HPW60	50° C	< 70 dB (A)	650x700x162 mm	236 kg	272 kg	2÷4 bar Ø 3/4"G
HPW80	50° C	< 70 dB (A)	810x700x162 mm	261 kg	300 kg	2÷4 bar Ø 3/4"G
HPW130	50° C	< 70 dB (A)	1320x700x162 mm	340 kg	380 kg	2÷4 bar Ø 3/4"G

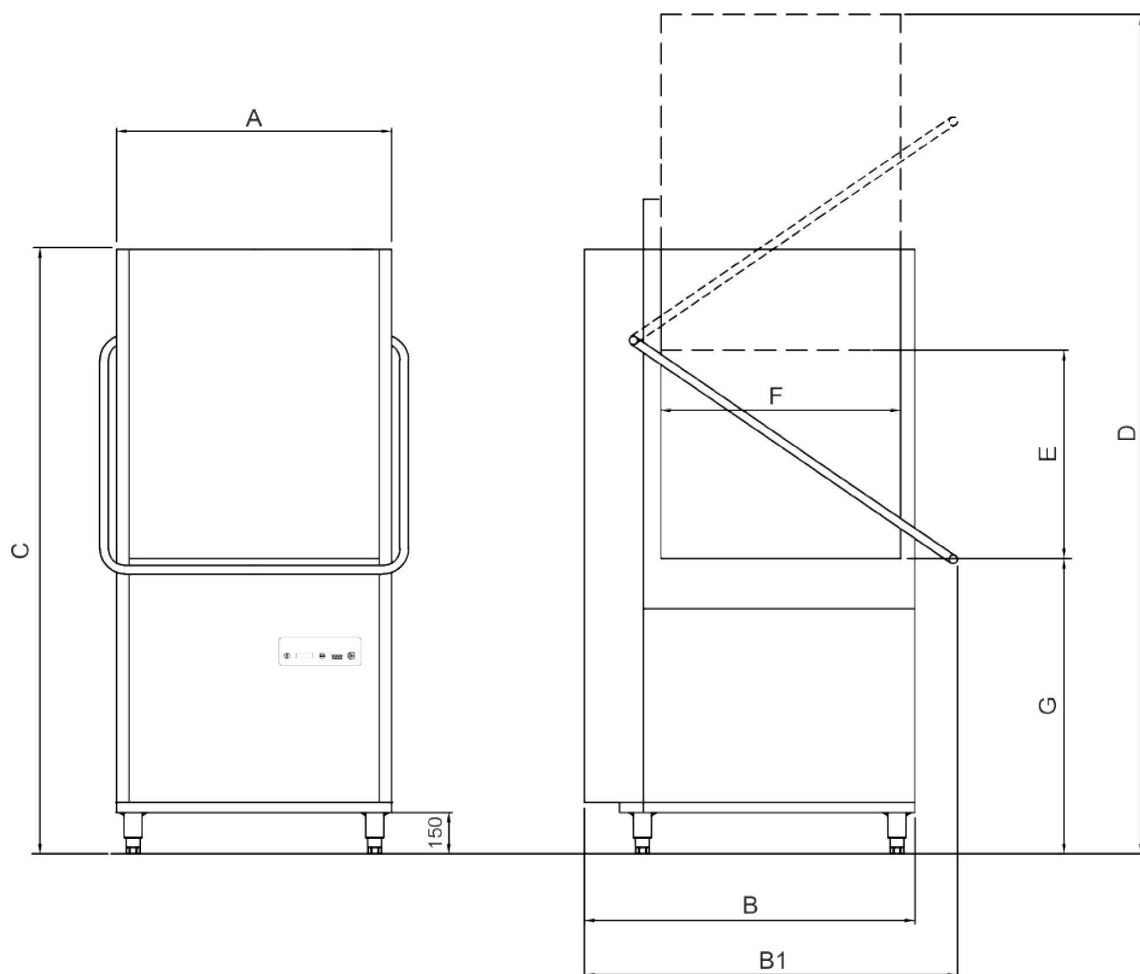

MODEL	A (mm)	B (mm)	B1 (mm)	C (mm)	D (mm)	E (mm)	F (mm)	G (mm)
HPW70 BT	820	1005	1110	1800	2500	620	700	880
HPW150 BT	1440	1005	1130	2100	2500	620	700	880

MODEL	Output in baskets/hour	Electrical connection	Total power	Boiler heating element	Tank heating element	Wash pump
HPW70	30/15/10/8	380-415V3N ~ 50Hz	9 kW	6 kW	6 kW	3 kW
HPW150	21/15/10/8	380-415V3N ~ 50Hz	15 kW	9 kW	9 kW	6 kW

MODEL	Tank capacity	Boiler capacity	Water cons. per cycle	Cycle length			
				Short	Medium	Long	Intensive
HPW70	90 L	10,5 L	4 L	1 120 s.	2 240 s.	3 360 s.	4 480 s.
HPW150	125 L	14,5 L	8 L	1 120 s.	2 240 s.	3 360 s.	4 480 s.

MODEL	Drain pipe fitting	Operating and storage temp.	Relative humidity	Wash temperature	Rinse temperature
HPW70	ø35	5° ÷ 40° C	20 ÷ 90 %	50° ÷ 60° C	80° ÷ 90° C
HPW150	ø35	5° ÷ 40° C	20 ÷ 90 %	50° ÷ 60° C	80° ÷ 90° C

MODEL	Water inlet max. temp.	Noise level	Basket dimensions	Net weight	Weight of packed machine	Water supply
HPW70	50° C	< 70 dB (A)	700x700 mm	230 kg	300 kg	2÷4 bar Ø 3/4"G
HPW150	50° C	< 70 dB (A)	1320x700 mm	300 kg	390 kg	2÷4 bar Ø 3/4"G

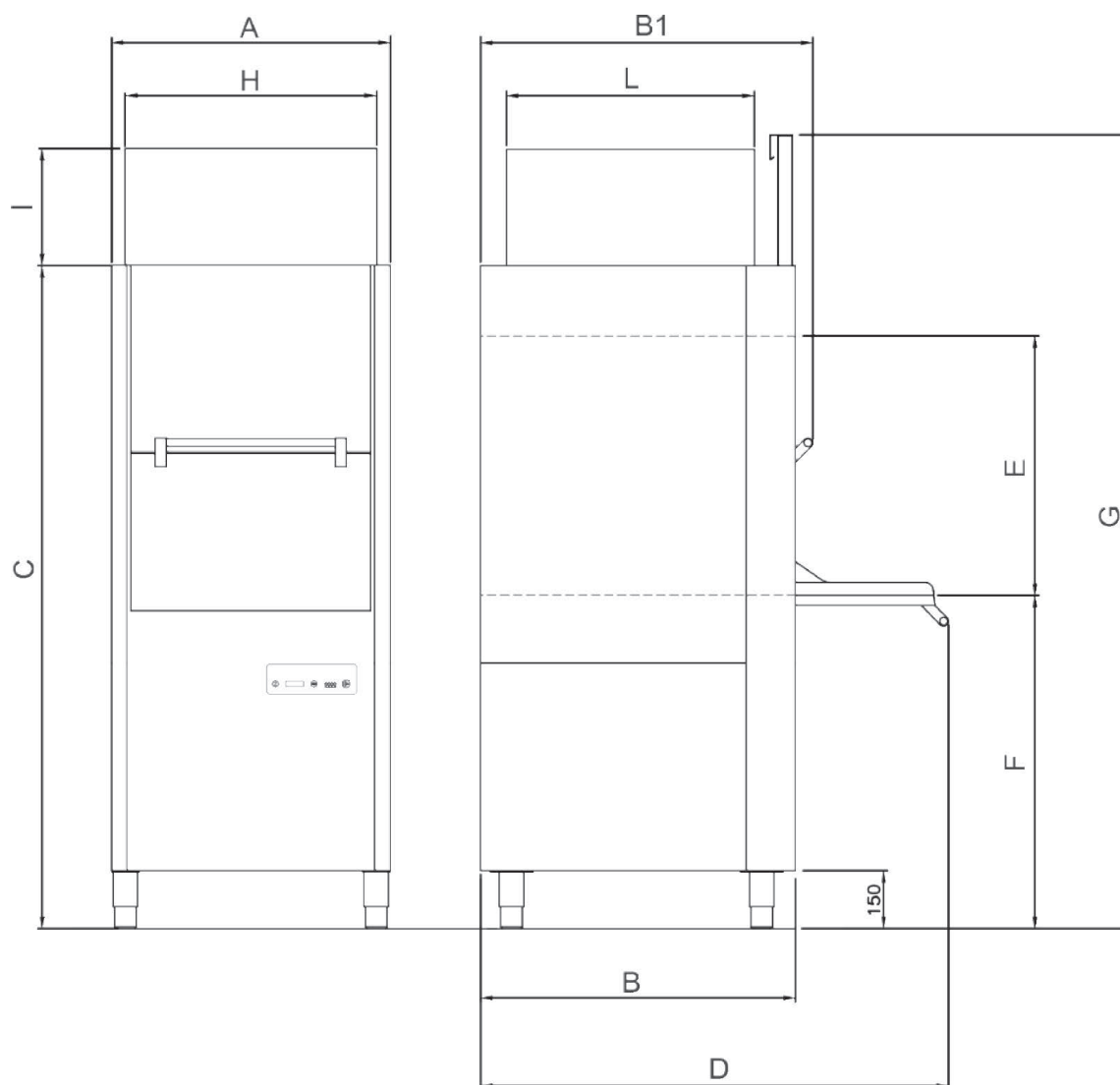

MODEL	A (mm)	B (mm)	B1 (mm)	C (mm)	D (mm)	E (mm)	F (mm)	G (mm)	HxLxL (mm)
HPW40 BT + RCC	720	814	858	1712	1208	670	860	2050	650x300x640
HPW40 ABT + RCC	720	814	858	1860	1358	820	860	2200	650x300x640

MODEL	Output in baskets/hour	Electrical connection	Total power	Boiler heating element	Tank heating element	Wash pump
HPW40 BT	21/15/10/8	380-415V3N ~ 50Hz	7,5 kW	6 kW	4 kW	1,5 kW
HPW40 ABT	21/15/10/8	380-415V3N ~ 50Hz	7,5 kW	6 kW	4 kW	1,5 kW

MODEL RCC	Tank capacity	Boiler capacity	Water cons. per cycle	Cycle length			
				Short	Medium	Long	Intensive
HPW40 BT	42 L	10,5 L	4,5 L	1 120 s.	2 240 s.	3 360 s.	4 480 s.
HPW40 ABT	42 L	10,5 L	4,5 L	1 120 s.	2 240 s.	3 360 s.	4 480 s.

MODEL RCC	Drain pipe fitting	Operating and storage temp.	Relative humidity	Wash temperature	Rinse temperature
HPW40 BT	ø 1 1/2"G	5° ÷ 40° C	20 ÷ 90 %	50° ÷ 60° C	80° ÷ 90° C
HPW40 ABT	ø 1 1/2"G	5° ÷ 40° C	20 ÷ 90 %	50° ÷ 60° C	80° ÷ 90° C

MODEL RCC	Water inlet max. temp.	Noise level	Basket dimensions	Net weight	Weight of packed machine	Water supply
HPW40 BT	50° C	< 70 dB (A)	540x660x120 mm	200 kg	236 kg	2÷4 bar Ø 3/4"G
HPW40 ABT	50° C	< 70 dB (A)	540x660x120 mm	200 kg	236 kg	2÷4 bar Ø 3/4"G

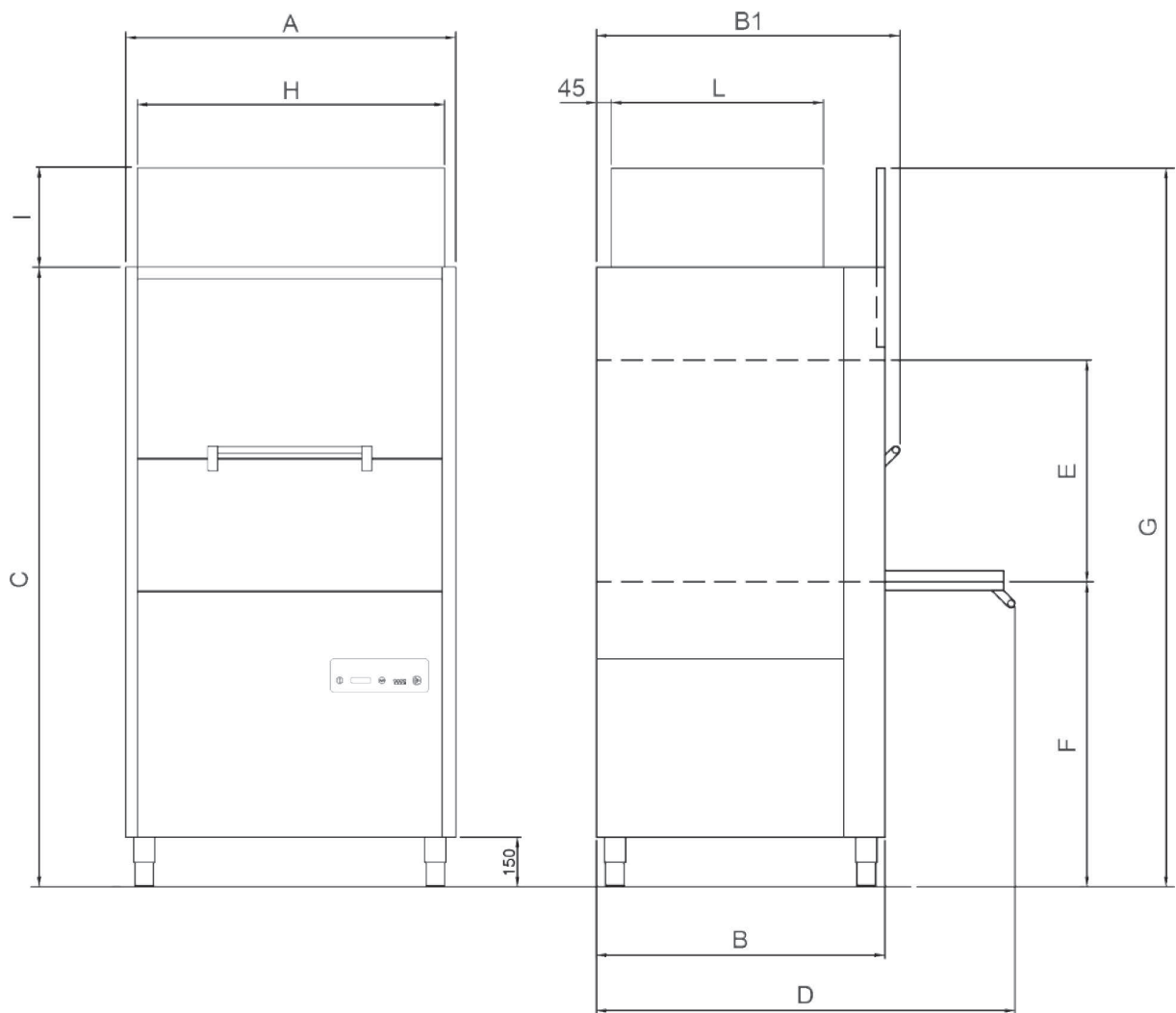

MODEL	A (mm)	B (mm)	B1 (mm)	C (mm)	D (mm)	E (mm)	F (mm)	G (mm)	HxLxL (mm)
HPW60 BT + RCC	836	870	915	1870	1263	670	920	2170	825x300x640
HPW60 ABT + RCC	836	870	915	2020	1413	820	920	2320	825x300x640
HPW80 BT + RCC	996	870	915	1870	1263	670	920	2170	920x300x640
HPW80 ABT + RCC	996	870	915	2020	1413	820	920	2320	920x300x640
HPW130 BT + RCC	1506	870	915	1870	1263	670	920	2170	920x300x640
HPW130 ABT + RCC	1506	870	915	2020	1413	820	920	2320	920x300x640

MODEL RCC	Output in baskets/hour	Electrical connection	Total power	Boiler heating element	Tank heating element	Wash pump
HPW60	30/15/10/8	380-415V3N ~ 50Hz	9 kW	6 kW	6 kW	3 kW
HPW80	30/15/10/8	380-415V3N ~ 50Hz	9 kW	6 kW	6 kW	3 kW
HPW130	30/15/10/8	380-415V3N ~ 50Hz	15 kW	9 kW	9 kW	6 kW

MODEL RCC	Tank capacity	Boiler capacity	Water cons. per cycle	Cycle length			
				Short	Medium	Long	Intensive
HPW60	82 L	14,5 L	4,5 L	1 120 s.	2 240 s.	3 360 s.	4 480 s.
HPW80	86 L	14,5 L	5 L	1 120 s.	2 240 s.	3 360 s.	4 480 s.
HPW130	132 L	14,5 L	8 L	1 120 s.	2 240 s.	3 360 s.	4 480 s.

MODEL RCC	Drain pipe fitting	Operating and storage temp.	Relative humidity	Wash temperature	Rinse temperature
HPW60	ø 1 1/2"G	5° ÷ 40° C	20 ÷ 90 %	50° ÷ 60° C	80° ÷ 90° C
HPW80	ø 1 1/2"G	5° ÷ 40° C	20 ÷ 90 %	50° ÷ 60° C	80° ÷ 90° C
HPW130	ø 1 1/2"G	5° ÷ 40° C	20 ÷ 90 %	50° ÷ 60° C	80° ÷ 90° C

MODEL RCC	Water inlet max. temp.	Noise level	Basket dimensions	Net weight	Weight of packed machine	Water supply
HPW60	50° C	< 70 dB (A)	650x700x162 mm	236 kg	272 kg	2÷4 bar Ø 3/4"G
HPW80	50° C	< 70 dB (A)	810x700x162 mm	261 kg	300 kg	2÷4 bar Ø 3/4"G
HPW130	50° C	< 70 dB (A)	1320x700x162 mm	340 kg	380 kg	2÷4 bar Ø 3/4"G

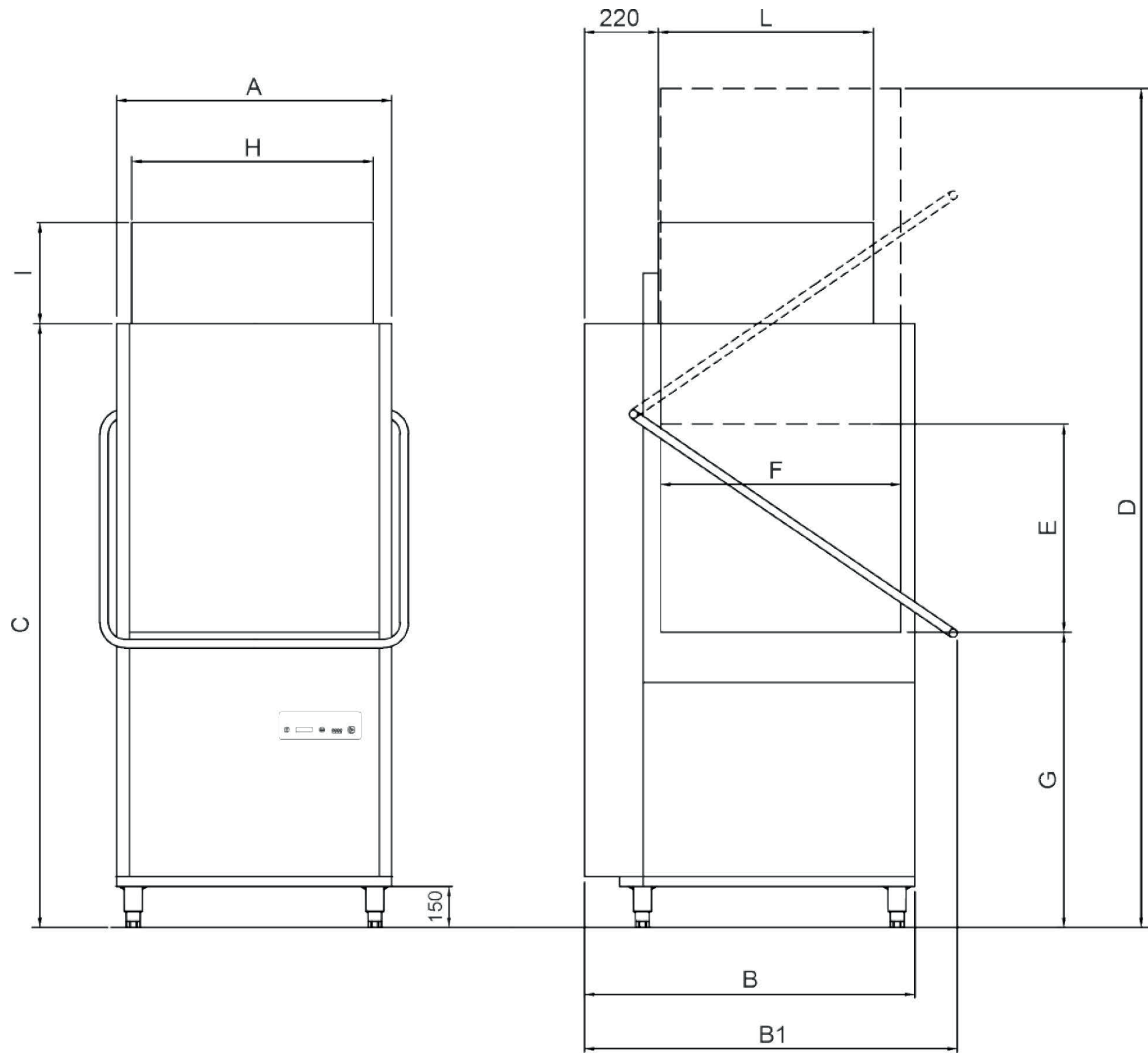

MODEL	A (mm)	B (mm)	B1 (mm)	C (mm)	D (mm)	E (mm)	F (mm)	G (mm)	HxLxL (mm)
HPW70 BT + RCC	820	1005	1110	1800	2500	620	700	880	720x300x640
HPW150 BT + RCC	1440	1005	1130	2100	2500	620	700	880	920x300x640

MODEL RCC	Output in baskets/hour	Electrical connection	Total power	Boiler heating element	Tank heating element	Wash pump
HPW70	30/15/10/8	380-415V3N ~ 50Hz	9 kW	6 kW	6 kW	3 kW
HPW150	21/15/10/8	380-415V3N ~ 50Hz	15 kW	9 kW	9 kW	6 kW

MODEL RCC	Tank capacity	Boiler capacity	Water cons. per cycle	Cycle length			
				Short	Medium	Long	Intensive
HPW70	90 L	10,5 L	4 L	1 120 s.	2 240 s.	3 360 s.	4 480 s.
HPW150	125 L	14,5 L	8 L	1 120 s.	2 240 s.	3 360 s.	4 480 s.

MODEL RCC	Drain pipe fitting	Operating and storage temp.	Relative humidity	Wash temperature	Rinse temperature
HPW70	ø35	5° ÷ 40° C	20 ÷ 90 %	50° ÷ 60° C	80° ÷ 90° C
HPW150	ø35	5° ÷ 40° C	20 ÷ 90 %	50° ÷ 60° C	80° ÷ 90° C

MODEL RCC	Water inlet max. temp.	Noise level	Basket dimensions	Net weight	Weight of packed machine	Water supply
HPW70	50° C	< 70 dB (A)	700x700 mm	230 kg	300 kg	2÷4 bar Ø 3/4"G
HPW150	50° C	< 70 dB (A)	1320x700 mm	300 kg	390 kg	2÷4 bar Ø 3/4"G

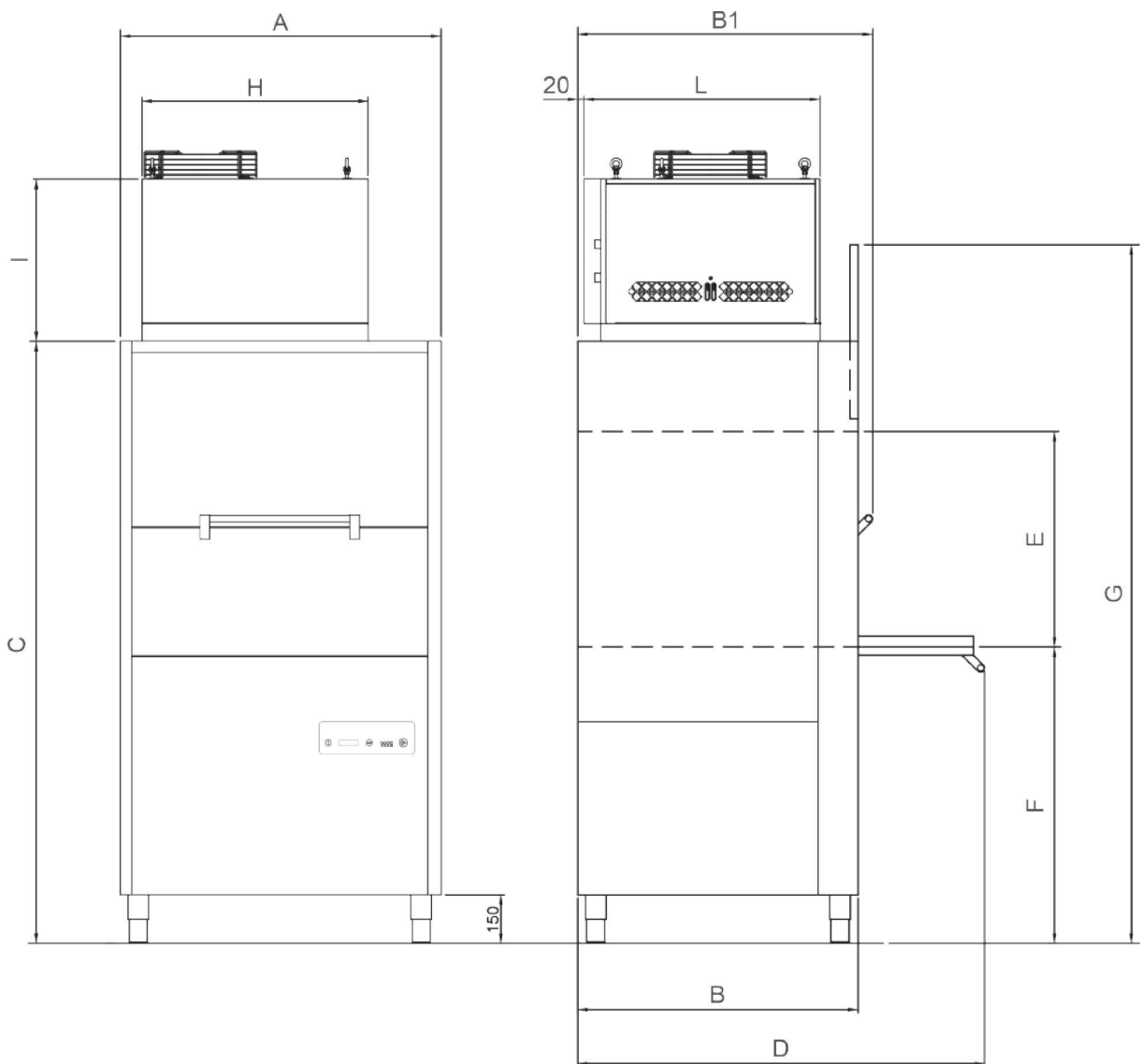

MODEL	A (mm)	B (mm)	B1 (mm)	C (mm)	D (mm)	E (mm)	F (mm)	G (mm)	HxLxL (mm)
HPW60 BT + HP2	836	870	915	1870	1263	670	920	2170	703x505x732
HPW60 ABT + HP2	836	870	915	2020	1413	820	920	2320	703x505x732
HPW80 BT + HP2	996	870	915	1870	1263	670	920	2170	703x505x732
HPW80 ABT + HP2	996	870	915	2020	1413	820	920	2320	703x505x732
HPW130 BT + HP2	1506	870	915	1870	1263	670	920	2170	703x505x732
HPW130 ABT + HP2	1506	870	915	2020	1413	820	920	2320	703x505x732

MODEL HP	Output in baskets/hour	Electrical connection	Total power	Boiler heating element	Tank heating element	Wash pump
HPW60	30/15/10/8	380-415V3N ~ 50Hz	9 kW	6 kW	6 kW	3 kW
HPW80	30/15/10/8	380-415V3N ~ 50Hz	9 kW	6 kW	6 kW	3 kW
HPW130	30/15/10/8	380-415V3N ~ 50Hz	15 kW	9 kW	9 kW	6 kW

MODEL HP	Tank capacity	Boiler capacity	Water cons. per cycle	Cycle length			
				Short	Medium	Long	Intensive
HPW60	82 L	14,5 L	4,5 L	1 120 s.	2 240 s.	3 360 s.	4 480 s.
HPW80	86 L	14,5 L	5 L	1 120 s.	2 240 s.	3 360 s.	4 480 s.
HPW130	132 L	14,5 L	8 L	1 120 s.	2 240 s.	3 360 s.	4 480 s.

MODEL HP	Drain pipe fitting	Operating and storage temp.	Relative humidity	Wash temperature	Rinse temperature
HPW60	ø 1 1/2"G	5° ÷ 40° C	20 ÷ 90 %	50° ÷ 60° C	80° ÷ 90° C
HPW80	ø 1 1/2"G	5° ÷ 40° C	20 ÷ 90 %	50° ÷ 60° C	80° ÷ 90° C
HPW130	ø 1 1/2"G	5° ÷ 40° C	20 ÷ 90 %	50° ÷ 60° C	80° ÷ 90° C

MODEL HP	Water inlet max. temp.	Noise level	Basket dimensions	Net weight	Weight of packed machine	Water supply
HPW60	50° C	< 70 dB (A)	650x700x162 mm	236 kg	272 kg	2÷4 bar Ø 3/4"G
HPW80	50° C	< 70 dB (A)	810x700x162 mm	261 kg	300 kg	2÷4 bar Ø 3/4"G
HPW130	50° C	< 70 dB (A)	1320x700x162 mm	340 kg	380 kg	2÷4 bar Ø 3/4"G

POMPA DI CALORE	Refrigerant gas	Max. oper. pressure	RH	Reduc. latent heat	Outlet air temp.	Power output	Pot. resa in caldo	Reduc. sens heat	Number air-cool
	R407C	30 bar	85 %	90 %	18 ~ 22° C				
HPW60			3,40A			2 kW	6,4 kW	1,2 kW	1700 Mc/h
HPW80			3,40A			2 kW	6,4 kW	1,46 kW	1700 Mc/h
HPW130			4,32A			2,6 kW	8,3 kW	2,44 kW	1600 Mc/h

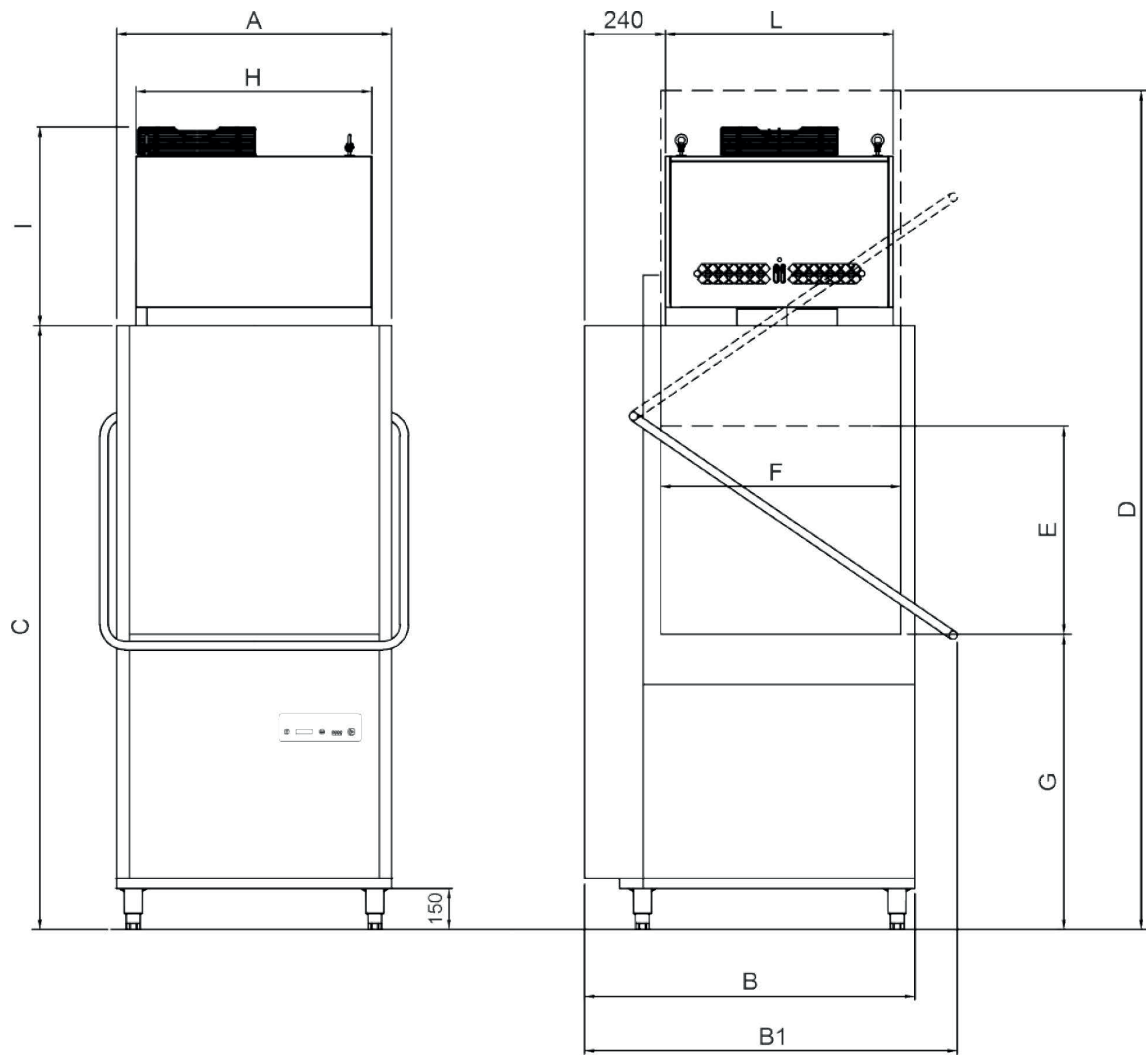

MODEL	A (mm)	B (mm)	B1 (mm)	C (mm)	D (mm)	E (mm)	F (mm)	G (mm)	HxLxL (mm)
HPW70 BT + WP2	820	1005	1110	1800	2500	620	700	880	703x590x680
HPW150 BT + WP3	1440	1005	1130	2100	2500	620	700	880	703x590x680

MODEL HP	Output in baskets/hour	Electrical connection	Total power	Boiler heating element	Tank heating element	Wash pump
HPW70	30/15/10/8	380-415V3N ~ 50Hz	9 kW	6 kW	6 kW	3 kW
HPW150	21/15/10/8	380-415V3N ~ 50Hz	15 kW	9 kW	9 kW	6 kW

MODEL HP	Tank capacity	Boiler capacity	Water cons. per cycle	Cycle length			
				Short	Medium	Long	Intensive
HPW70	90 L	10,5 L	4 L	1 120 s.	2 240 s.	3 360 s.	4 480 s.
HPW150	125 L	14,5 L	8 L	1 120 s.	2 240 s.	3 360 s.	4 480 s.

MODEL HP	Drain pipe fitting	Operating and storage temp.	Relative humidity	Wash temperature	Rinse temperature
HPW70	ø35	5° ÷ 40° C	20 ÷ 90 %	50° ÷ 60° C	80° ÷ 90° C
HPW150	ø35	5° ÷ 40° C	20 ÷ 90 %	50° ÷ 60° C	80° ÷ 90° C

MODEL HP	Water inlet max. temp.	Noise level	Basket dimensions	Net weight	Weight of packed machine	Water supply
HPW70	50° C	< 70 dB (A)	700x700 mm	230 kg	325 kg	2÷4 bar Ø 3/4" G
HPW150	50° C	< 70 dB (A)	1320x700 mm	310 kg	400 kg	2÷4 bar Ø 3/4" G

POMPA DI CALORE	Refrigerant gas	Max. oper. pressure	RH	Reduc. latent heat	Outlet air temp.	Power output	Pot. resa in caldo	Reduc. sens heat	Number air-cool
	R407C	30 bar	85 %	90 %	18 ~ 22° C				
HPW60			3,40A			2 kW	6,4 kW	1,46 kW	1700 Mc/h
HPW80			4,32 A			2,6 kW	8,3 kW	2,44 kW	1600 Mc/h